

LE2000

CORTLAND LEVER

ELECTRONIC KEYPAD LOCK

featuring

SC1 KEYWAY



**SMARTKEY
SECURITY™**



Scan to view
the LE2000
Product Video!

INNOVATIVE SECURITY

NEW FOR 2024!

Tell's LE2000 is a simple and secure electronic lock for a variety of commercial applications. This Grade 2 lever is ideal for offices, retail spaces, modular buildings, temporary construction access, public restrooms, storage closets and more.

The SmartKey Security™ features an SC1-keyway cylinder. You can rekey your masterkey right on the spot. One less key!

EASY INSTALLATION.

- Replaces existing door hardware with just a screwdriver
- No hard wiring needed
- Operates on a single 9V battery
- BHMA Certified Grade 2 in security, durability and finish
- Tested to 500,000 cycles



Back
(Interior Face)

SmartKey Security™ Makes it Easy to Re-key to Existing SC1 Keys!

- Allows up to 100,000 key combinations
- Optional one-key convenience for ALL locks with the SC1 keyway

RE-KEY IN SECONDS

■ Working Tell Key
■ Your Existing Key

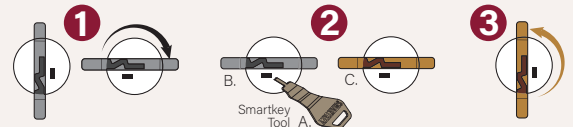

1. Insert the packaged key (working key), and rotate 90° clockwise until the keyhole is in the horizontal position.

2. Fully insert the Smartkey Tool into the small hole and then remove it.
3. Remove the working key.
4. Fully insert YOUR key that you would like to use into the keyhole.

Rotate the key 90° counter clockwise to return to the vertical position. The lock is now rekeyed to Your Key.

! You must have the working key to rekey the lock.



Commercial Grade 2
LE2000 CORTLAND LEVER
Electronic Keypad Lock

The LE2000 offers a range of easily programmable functions that allow managers to create and control up to 30 user access codes that can be customized for sharing with employees, maintenance personnel and service professionals. This sleek entry system operates on a single 9-volt battery and is available in two attractive finishes.



Rentals

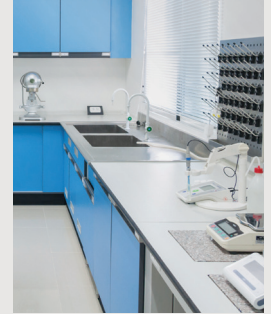

Labs/Restricted Areas

FEATURES

- Robust metallic design for enhanced durability
- BHMA commercial grade 2 certified
- Up to 3 year battery life
- Reversible lever to fit left-hand or right-hand doors
- Property managers can disable the Passage Mode so that it auto-locks every time and a key or code is always required for entry. This is ideal for restrooms in restaurants and gas stations.
- Up to 30 unique user access codes
- One-time user codes available for emergencies
- For added convenience, property managers can program the lock from the outside with a programming code.



CL103930
US26D Satin Chrome

SPECIFICATIONS

| | |
|-----------------------|--|
| Function | ▪ Keyed entry electronic lever |
| Door Prep | ▪ 2 1/8" diameter face hole & 1" diameter latch hole |
| Backset | ▪ Adjustable 2 3/8" or 2 3/4" |
| Door Thickness | ▪ 1 3/8" - 1 3/4" ▪ 2" kit option available, please call |
| Faceplates | ▪ 1" x 2 1/4" round corner standard |
| Strikes | ▪ Round corner, 2 3/4" x 1/8" ▪ Square corner, 2 3/4" x 1/8" |
| Latch | ▪ 6- way adjustable 2 3/8" - 2 3/4" Square latch Round latch Drive-in latch |
| Bolt | ▪ 1/2" throw, dead latch |
| Door Handing | ▪ Reversible |
| Cylinder | ▪ SmartKey Security™ SC1 Keyway* |
| ADA | ▪ Certified |
| UL Rating | ▪ 20 minute |



CL103931
US19 Matte Black

*Not compatible with Kwikset keys.

