



REFERENCE GUIDE AT A GLANCE

PROGRAMMING INSTRUCTIONS ELECTRONIC KEYPAD LOCK

LE2000 / KE2000

Featuring SmartKey Technology™ with an SC1 Keyway

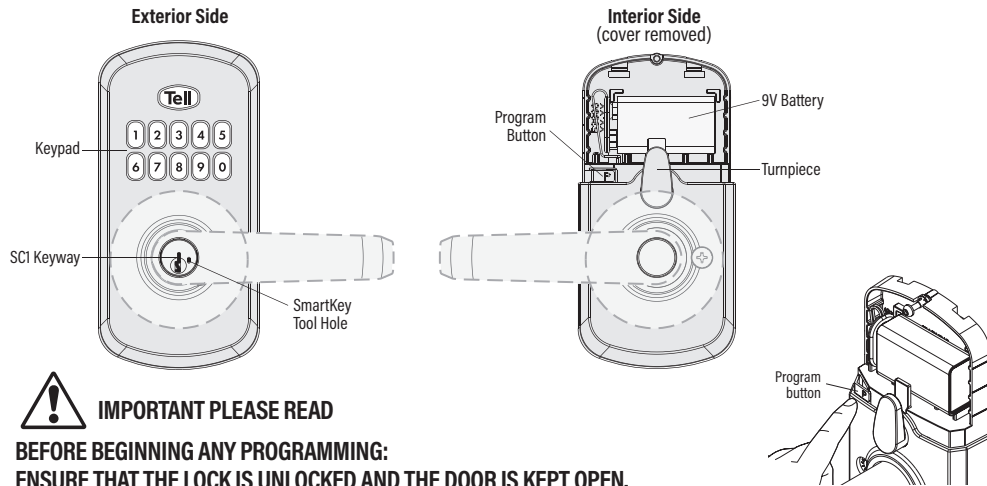

IMPORTANT PLEASE READ

**BEFORE BEGINNING ANY PROGRAMMING:
ENSURE THAT THE LOCK IS UNLOCKED AND THE DOOR IS KEPT OPEN.**

There are two ways to enter the programming mode. First, by pushing the Program Button (shown above in the diagram). A second method is by creating a Programming Code, which allows you to enter the programming mode if you don't have access to the interior of the lock. Please follow the instructions starting in Page 2 or follow the table reference below to begin programming.

Move swiftly during programming. If no digit is pressed for 10 seconds, the system will time out and you will need to restart the procedure.

PROGRAM	STEP 1	STEP 2	STEP 3	STEP 4	STEP 5	STEP 6	STEP 7	STEP 8	STEP 9
Create a Programming Code	Press Program Button	Listen for 2 beeps	Press 3	Press Tell Button	Enter 4 to 8 Digit Code	Press Tell Button	Re-Enter 4 to 8 Digit Code	Press Tell Button	Green Flash- Success, Red-Failed Attempt
Add User Code			Press 1	Press Tell Button	Enter 4 to 8 Digit Code	Press Tell Button	Green Flash- Success, Red-Failed Attempt	—	—
Add One-Time Code			Press 7	Press Tell Button	Enter 4 to 8 Digit Code	Press Tell Button	Green Flash- Success, Red-Failed Attempt	—	—
Delete User Code	Enter Program Code* →	Press Tell Button	Press 2	Press Tell Button	Enter Code You Wish to Delete	Press Tell Button	Re-Enter Code You Wish to Delete	Press Tell Button	Green Flash- Success, Red-Failed Attempt
Delete All User Code	or	or	Press 4	Press Tell Button	Enter 9-9-9-9-9-9	Press Tell Button	Re-Enter 9-9-9-9-9-9	Press Tell Button	Green Flash- Success, Red-Failed Attempt
Change Auto-lock Duration	Press Program Button →	Listen for 2 beeps	Press 8	Green Light Flash	Press Tell Button	Enter Delay Time (1-99 seconds)	Press Tell Button	Green Flash- Success, Red-Failed Attempt	—
Mute/Unmute Lock			Press 5	Green Light Flash	Press Tell Button	Green Flash- Success, Red-Failed Attempt	—	—	—
Enable/Disable User Code			Press 6	Press Tell Button	Green Flash- Success, Red-Failed Attempt	—	—	—	—
Enable/Disable Turnpiece			Press 9	Press Tell Button	Green Flash- Success, Red-Failed Attempt	—	—	—	—
Factory Reset	Press Program Button (approx 30 sec)	Long beep	Press and Release Program Button Again	—	—	—	—	—	—

*NOTE:

Programming Codes cannot be the same as User Code.

If you are using a Programming Code, the Program Button will be disabled except to factory reset the lock.

System Signals

Use Cases	Sound	Light
Correct user code entered to unlock door	2 short beeps	2 short green flashes
Lock auto-locks	1 long beep	1 long red flash
Turnpiece rotated to unlock position	2 short beeps	None
Turnpiece rotated to locked position	1 long beep	None
Low battery alarm	10 short beeps	10 short red flashes
3 incorrect user codes entered	15 long beeps	15 long red flashes
Entering factory reset mode after Program Button is pressed and held for 30 seconds.	1 long beep	None
Entering programming mode after pressing and releasing Program Button	2 beeps	None
Successful programming	1 long beep	1 long green flash
Unsuccessful programming	3 short beeps	3 short red flashes

TROUBLESHOOTING

Problem	Solution
Keypad is not responding.	Check battery.
Desired user code cannot be programmed.	For security reasons, the first 4 digits of each user code must be unique. For example, you cannot program a user code 4-8-1-5-1 as well as a user code 4-8-1-5-2.
Key cannot be removed when unlocked.	This is a feature to ensure the door is always locked and the key is removed (store room function). To remove the key, return the key to vertical position to remove.
Emergency egress function	This lock has an emergency egress function which allows you to exit by turning the lever on the inside, regardless of whether it is in Auto-lock or Passage mode.

PROGRAMMING FEATURES

How to Create a Programming Code

1. Make sure the door is open.
2. Press and release the Program button. You will hear two beeps.
3. Press **3**. You will hear one short beep and the keypad will flash green.
4. Press **TELL**.
5. Enter a Programming Code. It must be between 4 and 8 digits. The Programming Code cannot be the same as any user code.
6. Press **TELL**.

Please note that once a Programming Code is enabled, the Program button is disabled and can be used only to factory reset the lock.

How to Add Permanent or One-Time User Codes

1. Make sure the door is open.
2. If you have not enabled a Programming Code, press and release the Program button. You will hear two beeps. If you have enabled a Programming Code, enter your Programming Code, then press **TELL**. You will hear one short beep and the keypad will flash green.
3. Press **1** to add a permanent user code that can be used for entry at all times, until deleted. Press **7** to add a one-time user code. A one-time user code may be used only once, which will be deleted immediately after use (typically used in emergency cases when you need to give one-time access to a person). You will hear one short beep and the keypad will flash green.
4. Press **TELL**.
5. Enter a new User Code. It must be between 4 and 8 digits. For security reasons, the first 4 digits of each user code must be unique. For example, you cannot program a user code **4-8-1-5-1** as well as a user code **4-8-1-5-2**.
6. Press **TELL**. You will hear one long beep and the keypad will flash green if successful. If you hear three beeps and the keypad flashes red, it was unsuccessful. Repeat from step 1.

How to Enable/Disable User Codes

1. Make sure the door is open.
2. If you have not enabled a Programming Code, press and release the Program button. You will hear two beeps. If you have enabled a Programming Code, enter your Programming Code, then press **TELL**. You will hear one short beep and the keypad will flash green.
3. Press **6**. You will hear one short beep and the keypad will flash green.
4. Press **TELL**. You will hear one long beep and the keypad will flash green if successful. If you hear three beeps and the keypad flashes red, it was unsuccessful. Repeat from step 1.

How To Mute/Unmute Lock

If the lock is muted, you will not hear beeping during programming, normal operation, or system signals.

1. Make sure the door is open.
2. If you have not enabled a Programming Code, press and release the Program button. You will hear two beeps. If you have enabled a Programming Code, enter your Programming Code, then press **TELL**. You will hear one short beep and the keypad will flash green.
3. Press **5**. You will hear one short beep and the keypad will flash green.
4. Press **TELL**. You will hear one long beep and the keypad will flash green if successful. If you hear three beeps and the keypad flashes red, it was unsuccessful. Repeat from step 1.

How To Delete Individual User Codes

1. Make sure the door is open.
2. If you have not enabled a Programming Code, press and release the Program button. You will hear two beeps. If you have enabled a Programming Code, enter your Programming Code, then press **TELL**. You will hear one short beep and the keypad will flash green.
3. Press **2** to delete a user code. You will hear one short beep and the keypad will flash green.
4. Press **TELL**.
5. Enter the User Code you wish to delete. Press **TELL**.
6. Enter the User Code Again.
7. Press **TELL**. You will hear one long beep and the keypad will flash green if successful. If you hear three beeps and the keypad flashes red, it was unsuccessful. Repeat from Step 1.

How To Delete All User Codes

1. Make sure the door is open.
2. If you have not enabled a Programming Code, press and release the Program button. You will hear two beeps. If you have enabled a Programming Code, enter your Programming Code, then press **TELL**. You will hear one short beep and the keypad will flash green.
3. Press **4**. You will hear one short beep and the keypad will flash green.
4. Press **TELL**.
5. Enter **9-9-9-9-9-9**.
6. Press **TELL**.
7. Enter **9-9-9-9-9-9**.
8. Press **TELL**. You will hear one long beep and the keypad will flash green if successful. If you hear three beeps and the keypad flashes red, it was unsuccessful. Repeat from Step 1.

How To Change The Auto-Locking Duration

1. Make sure the door is open.
2. If you have not enabled a Programming Code, press and release the Program button. You will hear two beeps. If you have enabled a Programming Code, enter your Programming Code, then press **TELL**. You will hear one short beep and the keypad will flash green.
3. Press **8**. You will hear one short beep and the keypad will flash green.
4. Press **TELL**.
5. Enter delay time between 1-99 seconds.
6. Press **TELL**. You will hear one long beep and the keypad will flash green if successful. If you hear three beeps and the keypad flashes red, it was unsuccessful. Repeat from Step 1.

How To Enable/Disable Turnpiece Functionality

A Feature for Property Managers

If the turnpiece is disabled, the lock will always auto-lock after each entry. The turnpiece will rotate but will not activate passage mode. User code or key will always be required for entry.

1. Make sure the door is open.
2. If you have not enabled a Programming Code, press and release the Program button. You will hear two beeps. If you have enabled a Programming Code, enter your Programming Code, then press **TELL**. You will hear one short beep and the keypad will flash green.
3. Press **9**. You will hear one long beep and the keypad will flash green.
4. Press **TELL**. You will hear one long beep and the keypad will flash green if successful. If you hear three beeps and the keypad flashes red, it was unsuccessful. Repeat from Step 1.

Factory Reset

A factory reset will delete all codes associated with the lock.

1. Make sure the door is open and unlocked.
2. Press and hold the Program button until you hear one long beep (approximately 30 seconds), then release the Program button.
3. Press and release the Program button again. You will hear one short beep.
4. Test with an existing User Code, the lock should not work.

Important Safeguards

1. Read all instructions in their entirety.
2. Familiarize yourself with all warning and caution statements.
3. Remind all users of safety precautions.
4. Protect your user codes and programming code.
5. Dispose of used batteries according to local laws and regulations.

CAUTION: Prevent unauthorized entry. Since anyone with access to the back panel can change the user codes, you must restrict access to the back panel and routinely check the user codes to ensure they have not been altered without your knowledge. The use of a program code can help protect your system's settings.

WARNING: This Manufacturer advises that no lock can provide complete security by itself. This lock may be defeated by forcible or technical means, or evaded by entry elsewhere on the property. No lock can substitute for caution, awareness of your environment, and common sense. Builder's hardware is available in multiple performance grades to suit the application. In order to enhance security and reduce risk, you should consult a qualified locksmith or other security professional.

Regulatory Compliance

This product complies with standards established by the following regulatory bodies:

- Federal Communications Commission (FCC)
- Industry Canada

FCC

This device complies with Part 15 of the FCC Rules. Operation is subject to the following two conditions:

- (1) this device may not cause harmful interference, and
- (2) this device must accept any interference received, including interference that may cause undesired operation.

This equipment has been tested and found to comply with the limits for a Class B digital device, pursuant to Part 15 of the FCC Rules. These limits are designed to provide reasonable protection against harmful interference in a residential installation. This equipment generates, uses, and can radiate radio frequency energy and, if not installed and used in accordance with the instructions, may cause harmful interference to radio communications. However, there is no guarantee that interference will not occur in a particular installation. If this equipment does cause harmful interference to radio or television reception, which can be determined by turning the equipment off and on, the user is encouraged to try to correct the interference by one or more of the following measures:

- Reorient or relocate the receiving antenna.
- Increase the separation between the equipment and receiver.
- Connect the equipment into an outlet on a circuit different from that to which the receiver is connected.
- Consult the dealer or an experienced radio/TV technician for help.

IMPORTANT! Changes or modifications not expressly approved by the manufacturer could void the user's authority to operate the equipment.

Industry Canada

This device complies with Industry Canada licence-exempt RSS standard(s). Operation is subject to the following two conditions: (1) this device may not cause interference, and (2) this device must accept any interference, including interference that may cause undesired operation of the device.

CAUTION



Before you begin re-keying, please note the following precautions.

- Keep door open while re-keying
- Remove the lever or knob to avoid lock outs (reference installation manual on how to remove lever or knob)

SMARTKEY SECURITY RE-KEYING TECHNOLOGY — Re-Key the Lock in Seconds (if desired)

1. Insert the new lock's TELL Key and turn clockwise 90 degrees until the keyhole is in the horizontal position as shown below.

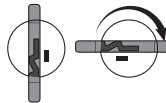

2. While the Tell Key is still inserted, push the Re-keying Tool completely into the small hole and remove the tool and then the TELL Key.

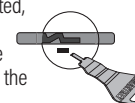

3. Now insert Your Key that you would like to use into the keyhole. Turn the key counter-clockwise 90 degrees to return back to the vertical position.

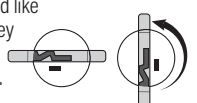

The lock is now re-keyed to Your Key.