

# REVERSIBLE PANIC / FIRE EXIT MORTISE LOCK DEVICES

## INSTALLATION INSTRUCTIONS

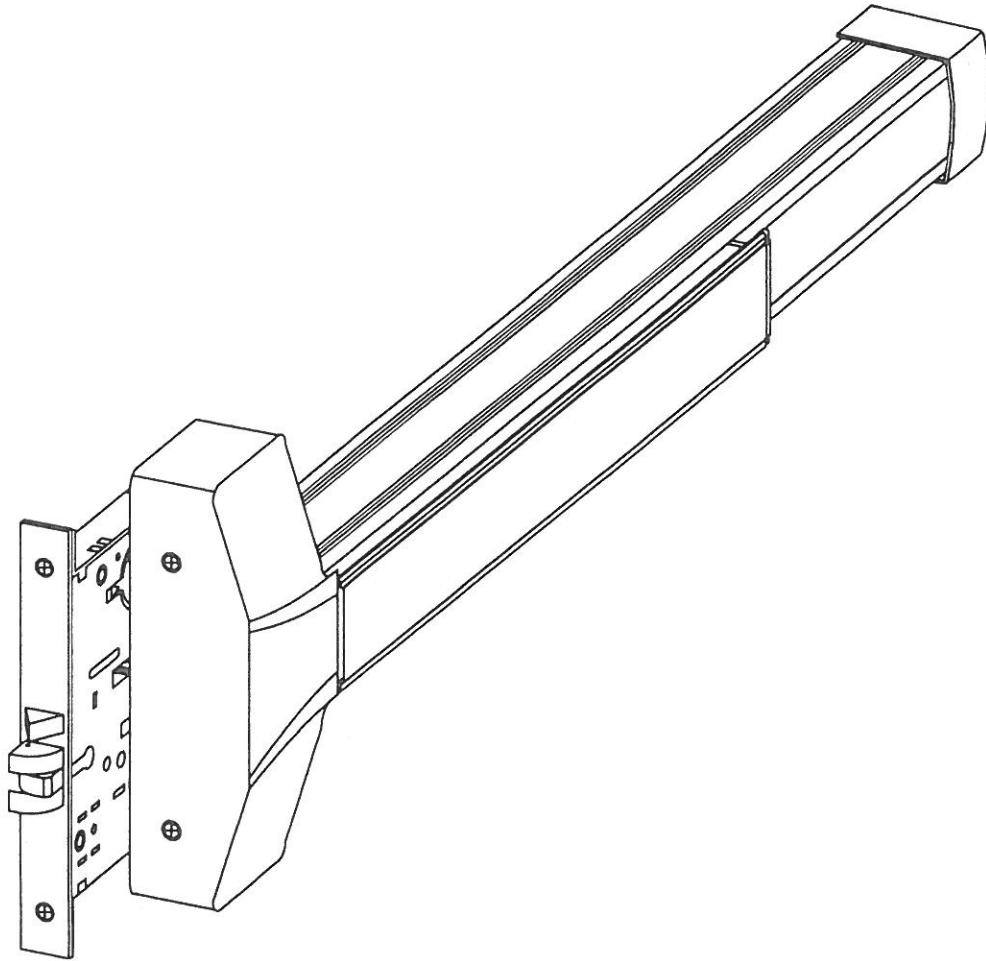

These instructions are presented in step by step sequence and attach a template to tape to your door and frame as an aid to preparing for device mounting.

Please read it throughout before installation.

*Note : The dimensions of Template are shown in inches. See attached page for the Metric Conversion Table if you used to read the millimeters.*

## DESIGNATION OF PARTS

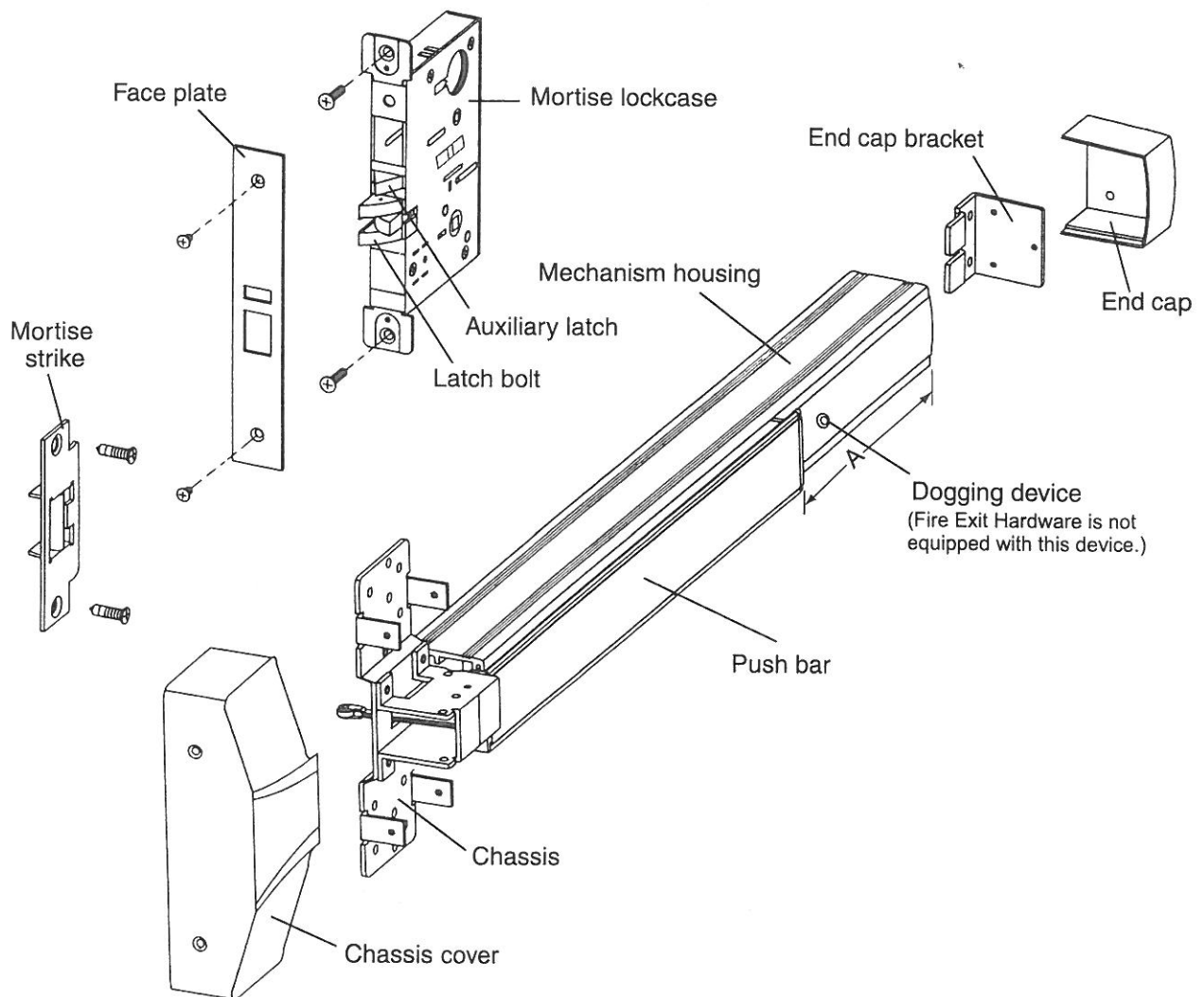

### **BEFORE INSTALLING THIS EXIT DEVICE :**

- 1. Check device to be sure the type is correct for the application.**
- 2. Check device for the correct length, finish and outside trim to be used.**

NOTE : This model device have 3 different lengths:

For use on 3' wide door device = Approx. 33"

For use on 3.5' wide door device = Approx. 40"

For use on 4' wide door device = Approx. 44"

The lengths of devices are precut for 36", 42" and 48" wide door use, no additional cutting is necessary. If narrow door installation is needed, cut device "A" portion to door width minus 4" to fit property.

## STEP 1 : MARK DOOR FOR DEVICE AND LOCK

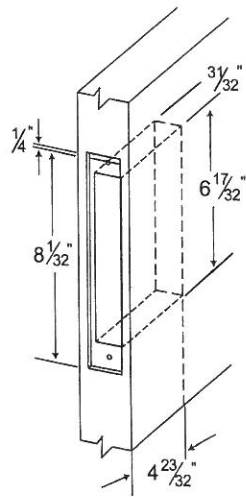

Figure 1-1

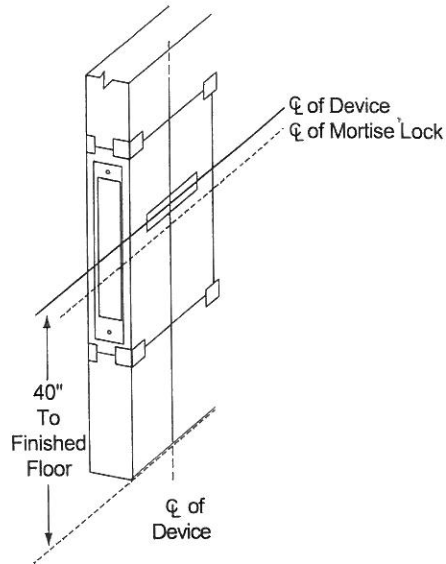

Figure 1-2

1. If door is already cut out for lock, check for proper clearance. (See Figure 1-1.)
2. Mark the center line of device by drawing a line across the door 40" above finished floor. (See Figure 1-2.)
3. Tape template to door and frame then mark mounting holes for device chassis and strike.
4. Cut-out and drill holes as marked on door and frame.

## STEP 2 : INSTALL STRIKE TO FRAME OR INACTIVE DOOR

1. Install strike to drilled position on frame or inactive door and secure into place with supplier screws. (See Figure 2-1 and Figure 2-2.)
2. Be sure auxiliary latch of lock does not enter strike opening.

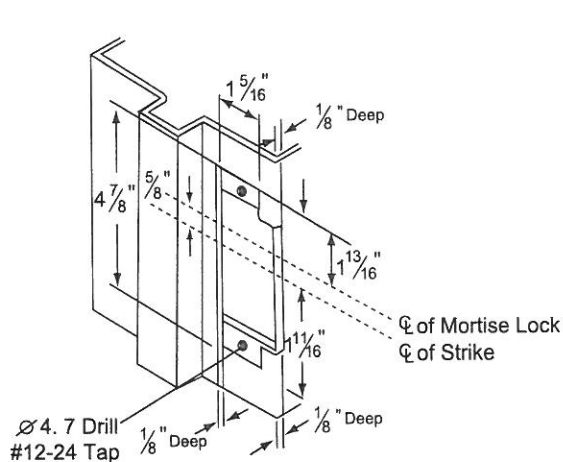

Figure 2-1  
To frame on single door

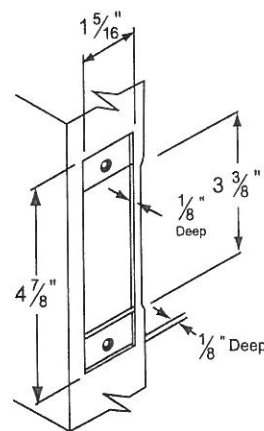
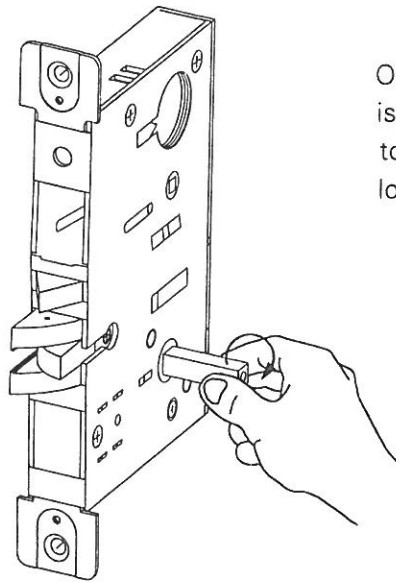

Figure 2-2  
To door edge of inactive door

- B) Check the hub of lock if it is seated in correct position before proceeding next step. Insert spindle into hub of lock case then turn it until latch bolt will be retracted. (See Figure 3-4.)



On one side of the chassis which is going to be installed with a trim, to check this step before insert the lock case into mortise cut-out.

Figure 3-4

#### STEP 4: INSTALL LOCK CASE TO DOOR

Insert lock case into mortise cut-out and fasten with two Flat Head screws to door. (See Figure 4.)

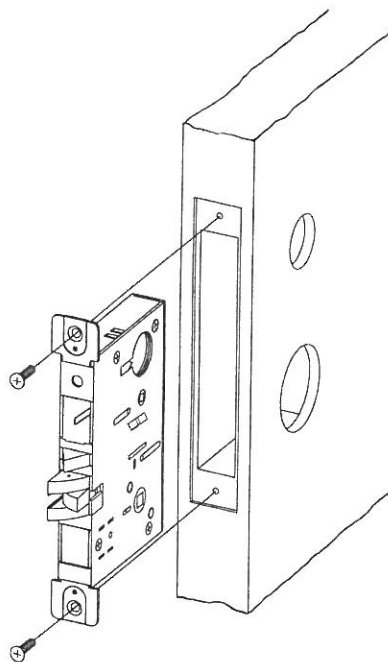

Figure 4

## STEP 5 : INSTALL DEVICE

1. Remove chassis cover from chassis assembly and end cap from end cap bracket.
2. Insert the Pull Finger beneath device chassis into the hole A in lock case ( see Figure 5-1), then mount device horizontally to the drilled position with supplied 6 screws to door. (See Figure 5-2.)
3. Place end cap bracket as a template, mark and drill holes then screw it to secure the device.
4. Check device for correct operation:
  - A. Depress Push Bar, latch bolt should retract to flush position.
  - B. Release Push Bar, latch bolt is fully extended.
5. Tighten all screws and bolts.

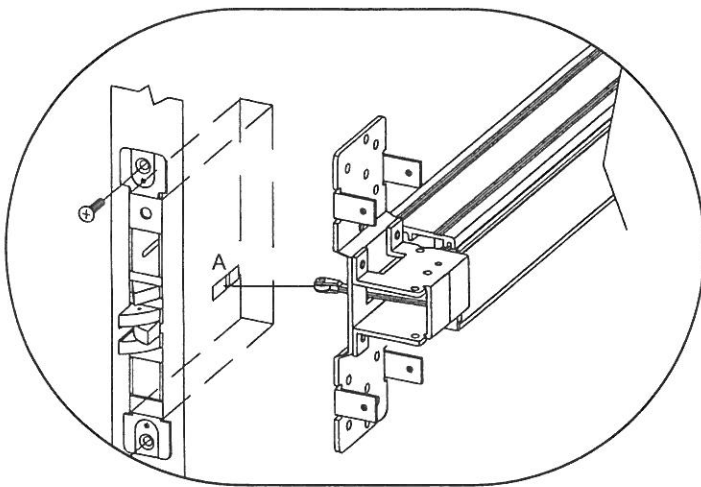

Figure 5-1

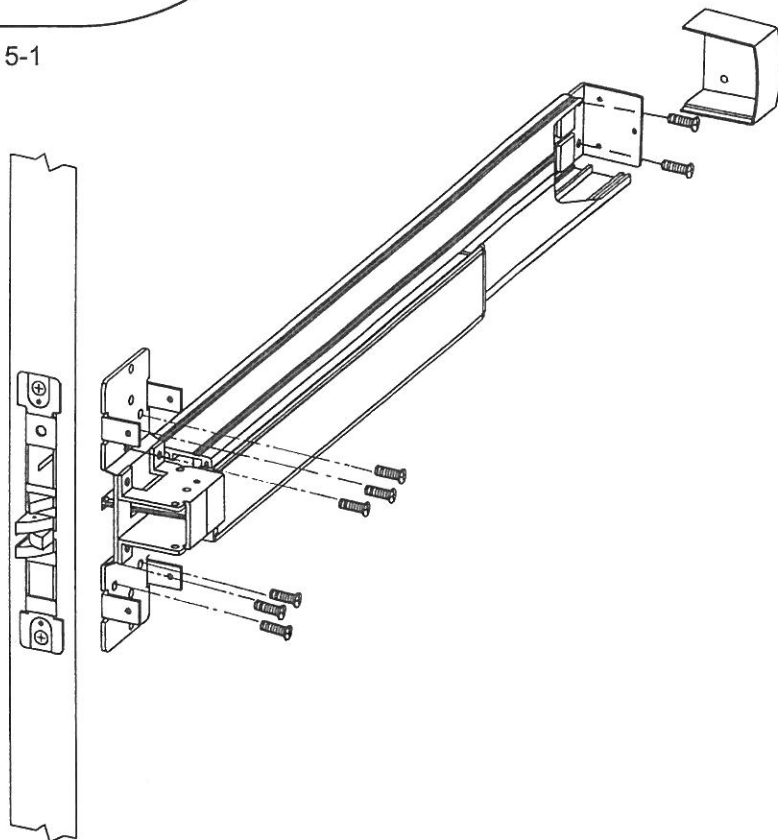

Figure 5-2

## STEP 6 : INSTALL OUTSIDE TRIM AND CYLINDER

Note : This step is for our Entry Lever trim used only, if other trim used with this device, please refer to its instructions.

1. Make sure the direction of outside lever to be installed, then place the reversible spring cage into ferrules with arrow pointing in direction of lever rotation and fasten with screws. (See Figure 6-1.)
2. Insert spindle into hub of spring cage on outside trim. (See Figure 6-2.)

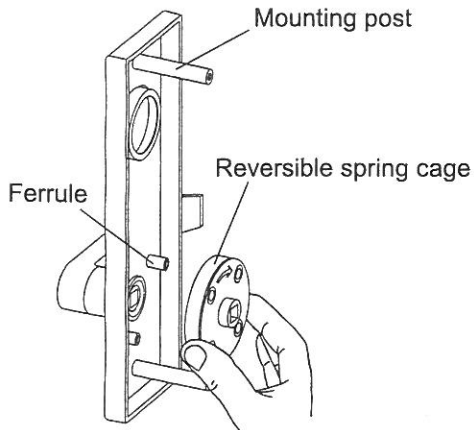

Figure 6-1

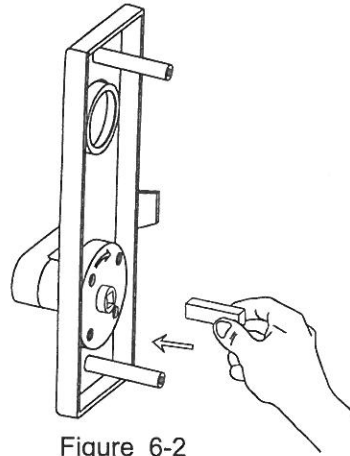

Figure 6-2

3. Install outside trim with mounting posts through door and position spindle into hub of lock case. (See Figure 6-3.)
4. Mount two long screws through device chassis into the mounting posts of outside trim.
5. Screw cylinder into threaded hole of lock case. (See Figure 6-4.)
6. Tighten the set screw against cylinder by counterclockwise as shown.

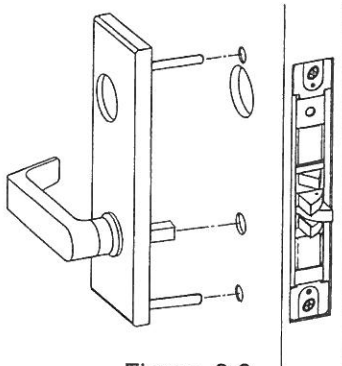

Figure 6-3

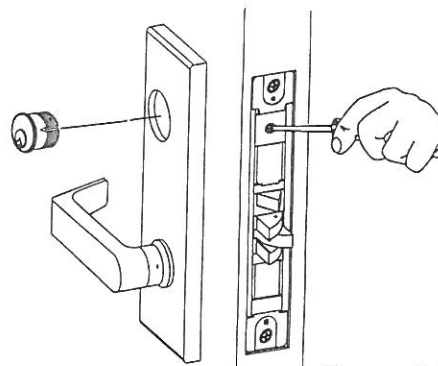

Figure 6-4

7. Install face plate onto lock case front and fasten with supplied screws. (See Figure 6-5.)

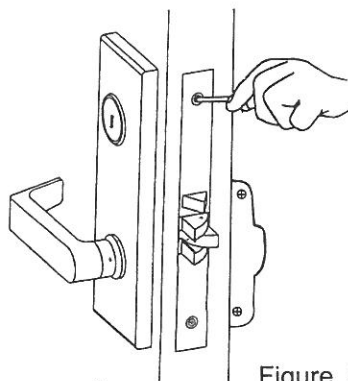

Figure 6-5

## STEP 7: TEST OPERATION AND INSTALL COVERS

1. Test push bar and dogging operation before installing covers:
  - A. No Trim : Latch bolt is retracted by depressing push bar inside.
  - B. With Trim : Latch bolt is retracted by push bar inside, and
    - a. When outside key locks the lever/knob, the lever/knob will be made inoperative.
    - b. When outside key unlocks the lever/knob, the lever/knob can retract latch bolt.
  - C. Dogging : See dogging description and chart below.
2. Make sure and secure latch bolt engagement.  
Adjust strike if required.
3. Install chassis cover on chassis assembly.
4. Install end cap on end cap bracket.

## Door Handing

Use this diagram to determine the hand of door.

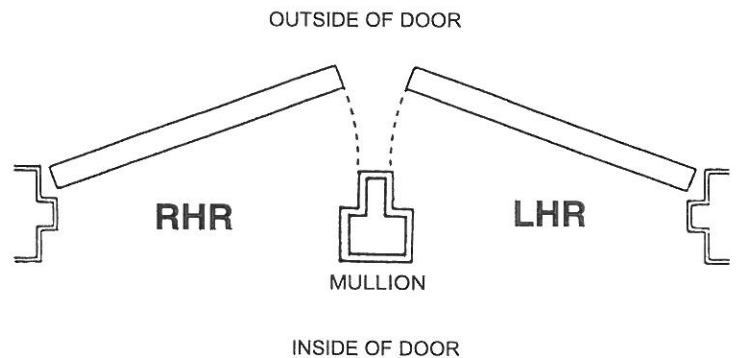

### **NOTE :**

***For extending the life of this device, dogging device during high traffic period of the day (Panic device only):***

#### **Dogging:**

Depress push bar,  
insert dogging wrench  
and turn clockwise 15°

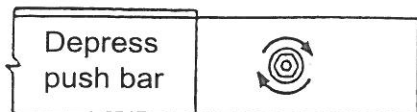

The push bar will remain pressed and the latches will keep retracted.

#### **Release dogging:**

Depress push bar,  
insert dogging wrench and  
turn counter-clockwise 15°

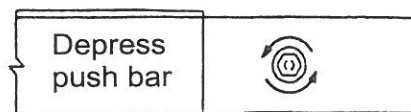

The push bar will return to up position and the latches will project to lock the door.

Dogging wrench  
(Alley key)

