

# SURFACE DOOR CLOSER

## INSTALLATION INSTRUCTIONS FOR THE 900 SERIES CLOSER

### DOOR CLOSER 900 SERIES INSTALLATION INSTRUCTION

#### STANDARD MOUNT (PULL SIDE)

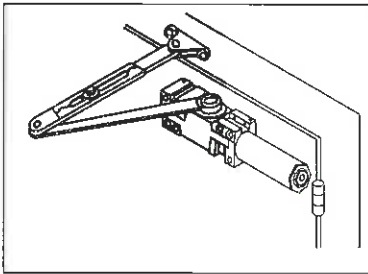

Permits 120° maximum opening  
See page 2

#### TOP JAMB MOUNT (PUSH SIDE)

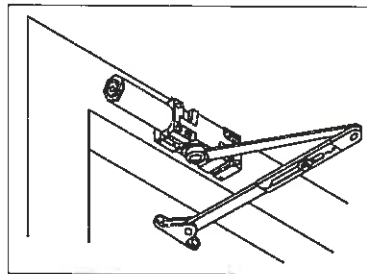

Permits 120° maximum opening  
See page 3

#### PARALLEL MOUNT (PUSH SIDE)

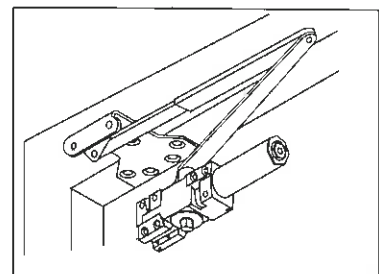

Permits 180° maximum opening  
Maximum butt size 5" x 5"  
See page 4

MAXIMUM DOOR WIDTH		FULL TURNS REQUIRED
EXTERIOR DOORS	INTERIOR DOORS	
—	5 lb-f*	5 TURNS C.C.W.
8.5 lb-f*	34" (864)	2 TURNS C.C.W.
30" (762)	36" (962)	0 TURNS
36" (914)	48" (1219)	5 TURNS C.W.
42" (1067)	54" (1372)	10 TURNS C.W.
48" (1219)	60" (1524)	15 TURNS C.W.

\*Opening Force on 36" Door

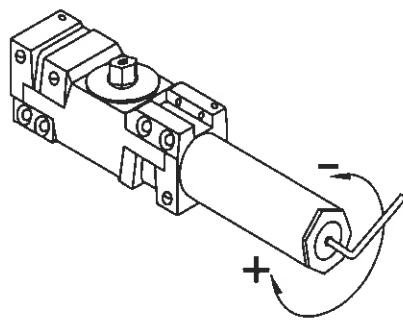
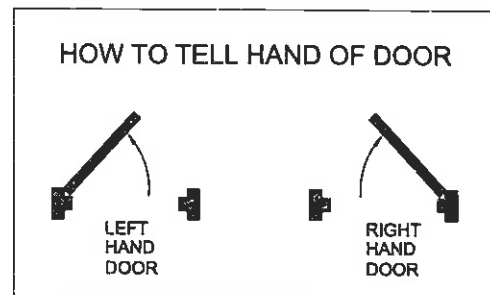

For more power, turn spring power adjuster clockwise and for less power turn counter clockwise. Do not exceed the maximum in either direction.

### Spring Power Adjustment

### CONTROL RANGE

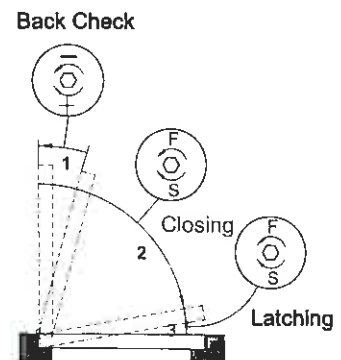

# PARALLEL ARM INSTALLATION CLOSER MOUNTED ON DOOR ON PUSH SIDE

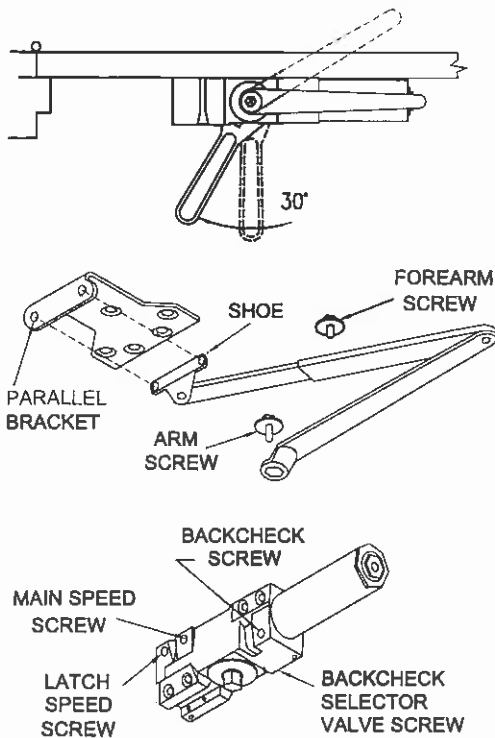
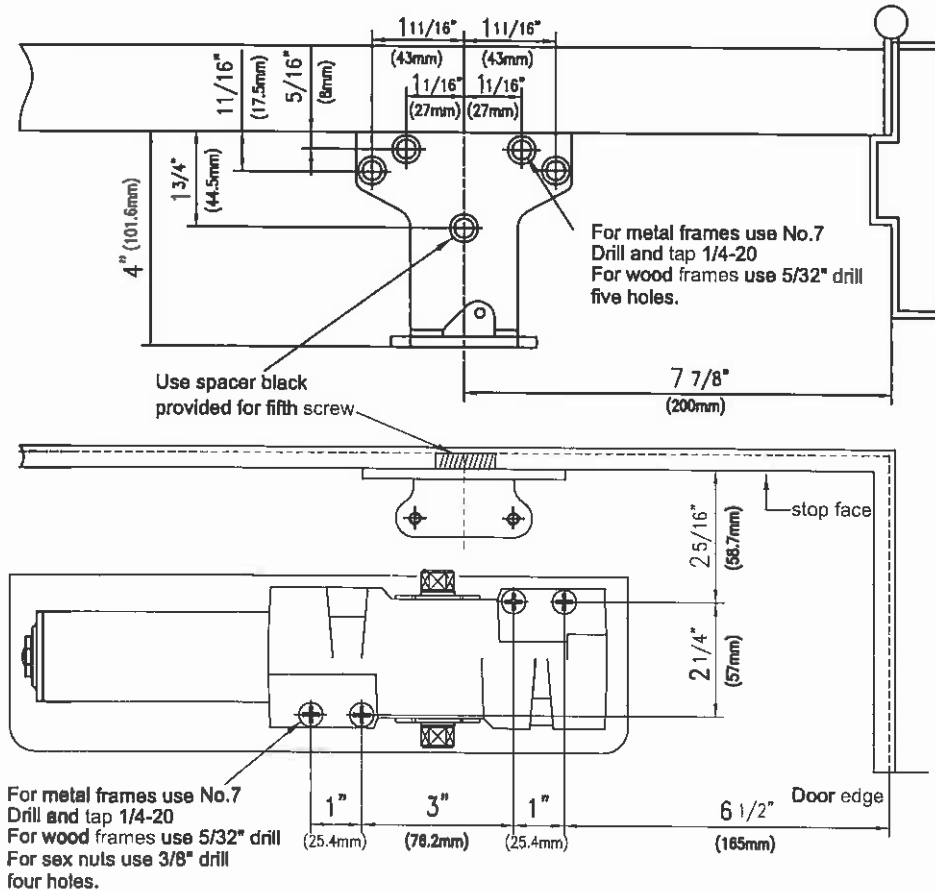

1. Before installation, (parallel arm), turn Back Check selector valve (found on the opposite side of closer) ALL THE WAY IN (CLOCKWISE).
2. Adjust spring power to match door width as indicated by chart on page 1.
3. Mount closer on door as dimensions shown. Tube end toward latch. If pivots are used, locate closer and parallel bracket from CENTERLINE OF PIVOT.
4. Place open end wrench on bottom shaft and turn toward hinge jamb about 30° and then place main arm on top shaft, insert arm screw into top of shaft and tighten.
5. Attach parallel bracket on frame as dimensions shown.
6. Attach rod and shoe to parallel bracket as shown.
7. Insert rod in forearm, and then insert main arm to closer parallel to door. Then insert forearm set screw and tighten.  
(IF HOLD OPEN ARM IS USED, THE NUT IS ON THE TOP FOR RH DOOR AND BOTTOM FOR LH DOOR)

### REGULATION:

A Normal closing time from 90° open position to door stop position is 5-7 secs, evenly divided between main swing speed and latch swing speed. Use hex key (furnished) to adjust speed. To slow main speed of door, turn regulating screw near shaft clockwise. To slow latch speed, turn regulating screw nearest latch clockwise.

### BACK CHECK

To increase back-check force, turn regulating screw nearest hinge clockwise. DO NOT USE ABRUPT BACKCHECK OR EXPECT DOOR CLOSER TO ACT AS A DOOR STOP.

### COVER

Place Insert in proper cutout, then push cover against door frame. Tighten both cover screw securely.

### HOLD OPEN ADJUSTMENT

Loose adjusting nut, open door to desired hold open position and tighten nut. Do not permit door to swing while hold open is setting.

# TOP JAMB INSTALLATION CLOSER MOUNTED TOP JAMB ON PUSH SIDE OF DOOR

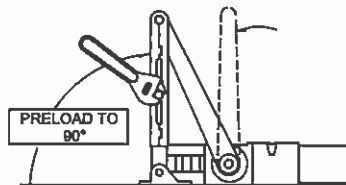
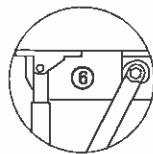
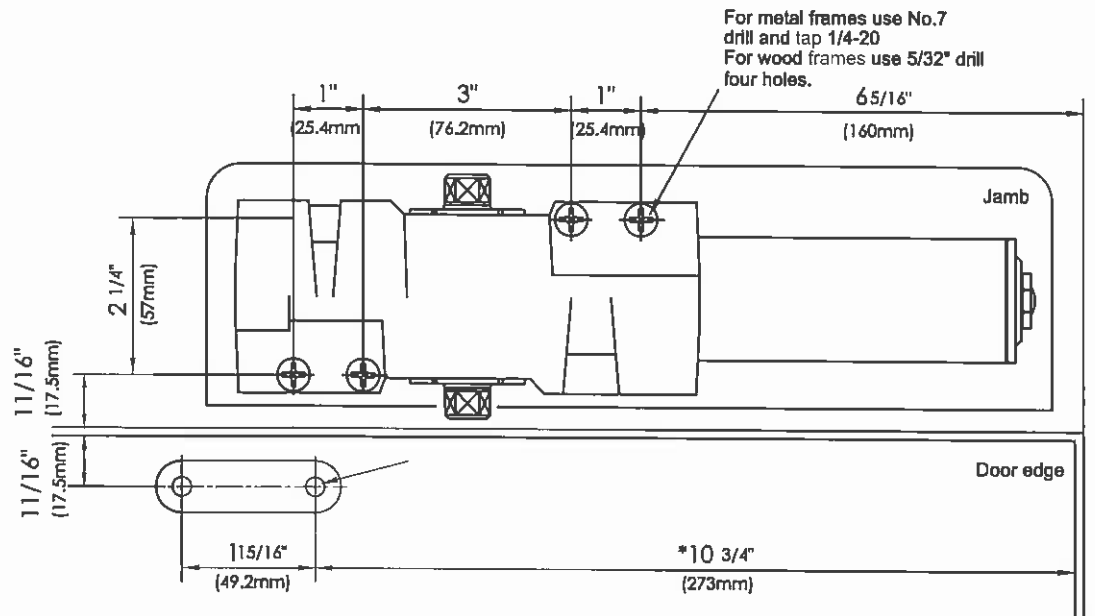

1. Adjust spring power to match door width as indicated by chart on front page.
2. Mount closer on jamb as dimension shown. Tube end toward hinge. If pivots are used, locate closer and shoe from CENTERLINE OF PIVOT. (For offset pivots, pls increase the marked dimensions by 1/8")
3. Place main arm on top of shaft 100° to closer body, insert arm screw into top of shaft and tighten.
4. Attach shoe to frame as shown. (If more latching power is required, rotate shoe 180°)
5. Open door and insert rod in forearm—for reveal 2 5/8" through 4 13/16" use long rod. For reveals 4 7/8" to 8" use FOREARM EXTENDER (ROD)—available from dealer.
6. With forearm at right angle to door (90°), insert forearm set screw and tighten. (IF HOLD OPEN ARM IS USED, THE NUT IS ON THE TOP FOR RH DOOR AND BOTTOM FOR LH DOOR)

## REGULATION:

A Normal closing time from 90° open position to door stop position is 4-6 secs, evenly divided between main swing speed and latch swing speed. Use Hex key (furnished) to adjust speed. To slow main speed of door, turn regulating screw near shaft clockwise. To slow latch speed, turn regulating screw nearest latch clockwise.

## BACK CHECK

To increase back-check force, turn regulating screw nearest hinge clockwise. DO NOT USE ABRUPT BACKCHECK OR EXPECT DOOR CLOSER TO ACT AS A DOOR STOP.

## COVER

Place insert in proper cutout, then push cover against door frame. Tighten both cover insert screw securely.

## HOLD OPEN ADJUSTMENT (90° to 120°)

Loose adjusting nut, open door to desired hold open position and tighten nut. Do not permit door to swing while hold open is setting.

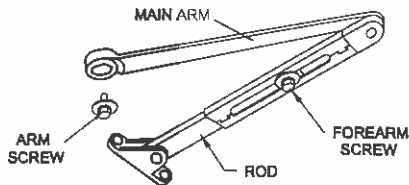
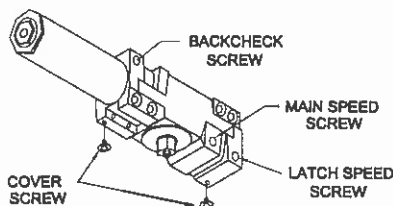

# STANDARD INSTALLATION

## CLOSER MOUNTED ON DOOR ON PULL SIDE

For metal frames use No.7  
drill and tap 1/4-20  
For wood frames use 5/32" drill  
two holes.

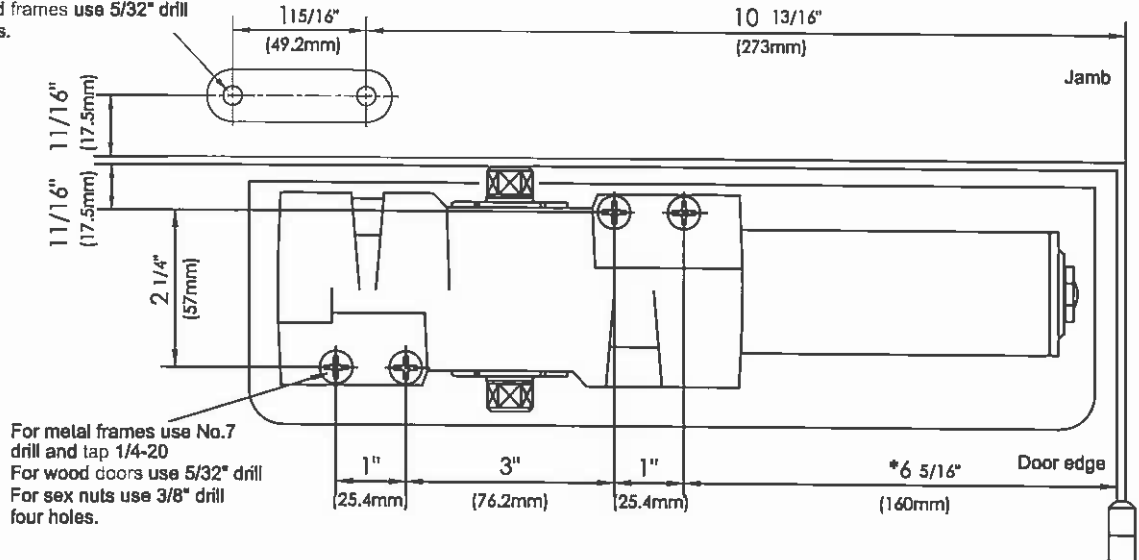

For metal frames use No.7  
drill and tap 1/4-20  
For wood doors use 5/32" drill  
For sex nuts use 3/8" drill  
four holes.

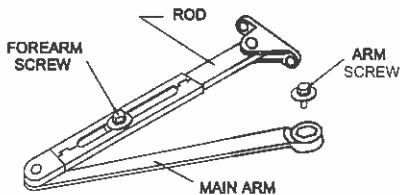
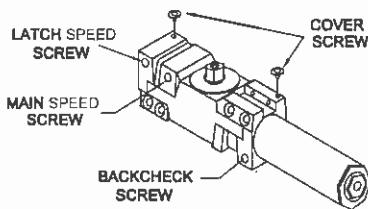
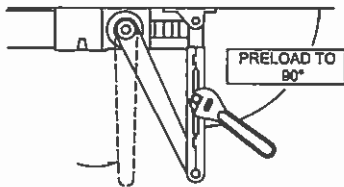
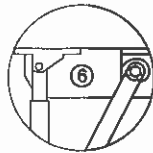

1. Adjust spring power to match door width as indicated by chart on front page.
2. Mount closer on door as dimensions shown. Tube end toward hinge. If pivots are used, locate closer and shoe from CENTERLINE OF PIVOT.  
(For offset pivots, pls increase the marked dimensions by 1/8")
3. Place main arm on top of shaft 100° to closer body, insert arm screw into top of shaft and tighten.
4. Attach shoe to frame as shown. (If more latching power is required, rotate shoe 180°)
5. Open door and insert rod in forearm.
6. With forearm at right angle to door (90°), insert forearm set screw and tighten.  
(IF HOLD OPEN ARM IS USED, THE NUT IS ON THE TOP FOR RH DOOR AND BOTTOM FOR LH DOOR)

### REGULATION:

A 'Normal' closing time from 90° open position to door stop position is 5-7 secs, evenly divided between main swing speed and latch swing speed. Use Hex key (furnished) to adjust speed. To slow main speed of door, turn regulating screw near shaft clockwise. To slow latch speed, turn regulating screw nearest latch clockwise.

### BACK CHECK

To increase back-check force, turn regulating screw nearest hinge clockwise. DO NOT USE ABRUPT BACKCHECK OR EXPECT DOOR CLOSER TO ACT AS A DOOR STOP.

### COVER

Place insert in proper cutout, then push cover against door frame. Tighten both cover screw securely.

### HOLD OPEN ADJUSTMENT (90° to 120°)

Loose adjusting nut, open door to desired hold open position and tighten nut. Do not permit door to swing while hold open is setting.